



ASME SECTION VIII
LIQUID, STEAM
AND AIR SERVICE

- BALL VALVES
- AUTOMATION & CONTROLS
- BACKFLOW PREVENTERS
- BUTTERFLY VALVES
- FORGED STEEL VALVES



500 series multi-purpose safety relief valves

- SAFETY RELIEF VALVES
- STRAINERS
- PUMPING & HEATING PRODUCTS
- IN-LINE CHECK VALVES



TABLE OF CONTENTS



Correction Factors	3
Model Numbering System	3
Valve Materials and Dimensions	4
Materials of Construction	5
Pressure and Temperature Limits	5
UV Steam Capacity	6
UV Air	7
UV Water	8
UV Steam Capacity (Metric)	9
UV Air (Metric)	10
UV Water (Metric)	11

ASME Section VIII "UV" Steam, Air / Gas and Liquid Service

National Board Certified Flow Capacities
 Bronze, Carbon Steel or All - Stainless Steel
 Materials of Construction
 Sizes 1/2" through 2", Pressure Settings to
 900 PSIG @ 800°F
 CSA B51 CRN OG2663.1C

Features and Benefits

- Wide Range of Materials and Options
- One Trim Design is Suitable for Steam, Air / Gas and Liquid Service
- High Capacity Full Nozzle Design
- Stainless Steel Springs
- Integral Lift Stop
- Self - Aligning Pivoting Disc
- API 527 Seat Tightness
- Tuned Blowdown - Short and Adjustable
- Backpressure Tight Design Minimizes Fugitive Emissions

Applications

- Pressure Vessels and Pressure Piping Systems
- Pumps, Tanks and Hydraulic Systems
- Thermal Relief of Liquid Filled Vessels
- Chemical and other Process Plants
- Power Plant Auxiliary Systems
- Cryogenic and Industrial Gases
- Air Compressors and Dryers
- Pressure Reducing Stations
- Vacuum Relief

Options

- Screwed Cap (standard), Packed Lift Lever
- Test gags
- Elastomer or Teflon® Soft Seat for Exceptional Seat Tightness
- High Temperature Alloy Springs for 550 - 800°F Service
- Special Cleaning Available
- Cryogenic Preparation (Consult factory)

Valve Sizing and Selection

The charts on the following pages contain the National Board certified flow ratings for air, steam and water at standard conditions as specified in ASME Section VIII, Div. 1 UG-129 and UG-131. Common correction factors are provided to calculate the effects of minor variations from these standard conditions.

Knowing the set pressure, required relieving capacity, service fluid and conditions, use these charts to determine the orifice letter corresponding to the flow area required to meet or exceed the flow requirements. Then refer to the Model Numbering and Dimensions charts to select the connections and materials best suited to the application.

For further information regarding the sizing and selection of pressure relief valves, or to calculate the flow of other types of fluids or at other conditions, please refer to ASME Section VIII, Div. 1 Part UG including Appendix 11, and ANSI/API RP 520 Part I.

Superheated Correction Factors, K_{sh}

Set Pressure (pounds per sq. inch gauge)	Temperature (Degrees Fahrenheit)					
	300	400	500	600	700	800
15	1.00	0.98	0.93	0.88	0.84	0.80
20	1.00	0.98	0.93	0.88	0.84	0.80
40	1.00	0.99	0.93	0.88	0.84	0.81
60	1.00	0.99	0.93	0.88	0.84	0.81
80	1.00	0.99	0.93	0.88	0.84	0.81
100	1.00	0.99	0.94	0.89	0.84	0.81
120	1.00	0.99	0.94	0.89	0.84	0.81
140	1.00	0.99	0.94	0.89	0.85	0.81
160	1.00	0.99	0.94	0.89	0.85	0.81
180	1.00	0.99	0.94	0.89	0.85	0.81
200	1.00	0.99	0.95	0.89	0.85	0.81
220	1.00	0.99	0.95	0.89	0.85	0.81
240	-	1.00	0.95	0.90	0.85	0.81
260	-	1.00	0.95	0.90	0.85	0.81
280	-	1.00	0.96	0.90	0.85	0.81
300	-	1.00	0.96	0.90	0.85	0.81
350	-	1.00	0.96	0.90	0.86	0.82
400	-	1.00	0.96	0.91	0.86	0.82
500	-	1.00	0.96	0.92	0.86	0.82
600	-	1.00	0.97	0.92	0.87	0.82
800	-	-	1.00	0.95	0.88	0.83
1000	-	-	1.00	0.96	0.89	0.84

Steam, Air, Gas And Liquid Correction Factors

AIR & GAS TEMPERATURE CORRECTION					
Temp °F	Kt	Temp °F	Kt	Temp °F	Kt
0	1.063	140	0.931	380	0.787
10	1.052	160	0.916	400	0.778
20	1.041	180	0.901	420	0.769
30	1.030	200	0.888	440	0.760
40	1.020	220	0.874	460	0.752
50	1.010	240	0.862	480	0.744
60	1.000	260	0.850	500	0.736
70	0.991	280	0.838	550	0.718
80	0.981	300	0.827	600	0.700
90	0.972	320	0.816	650	0.684
100	0.964	340	0.806	700	0.670
120	0.947	360	0.796	750	0.656

To correct for temperatures other than 60°F at the valve inlet, multiply the SCFM from the capacity tables by factor Kt.

SPECIFIC GRAVITY CORRECTION					
Specific Gravity	Ksg	Specific Gravity	Ksg	Specific Gravity	Ksg
0.07	3.770	0.75	1.155	1.40	0.845
0.08	3.530	0.80	1.117	1.50	0.817
0.09	3.333	0.85	1.085	1.60	0.791
0.10	3.160	0.90	1.055	1.70	0.768
0.20	2.240	0.95	1.025	1.80	0.745
0.30	1.825	1.00	1.000	1.90	0.725
0.40	1.580	1.05	0.975	2.00	0.707
0.50	1.414	1.10	0.955	2.50	0.633
0.55	1.350	1.15	0.933	3.00	0.577
0.60	1.290	1.20	0.913	3.50	0.535
0.65	1.240	1.25	0.895	4.00	0.500
0.70	1.195	1.30	0.877	4.50	0.471

To correct for specific gravities other than air or water (=1.0) multiply the SCFM or GPM from the capacity tables by factor Ksg.

Model Numbering System 500 Series Safety Relief valve

POSITION											
1	2	3	4	5	6	7	8	9	10	11 12 13 14	
SERIES BODY/TRIM MAT'L		CAP	ORIFICE SIZE		INLET	CONNECTION	SERVICE	SEAT	SPECIAL OPTIONS		SET PRESSURE
5	2	3	J	H	B	K	M	A	A	0 4 2 5	
51=BRONZE/BRASS 52=BRONZE/ STAINLESS 53=CARBON/ STAINLESS 54=ALL STAINLESS	1=SCREWED CAP 2=SCREWED + GAG 3=PACKED LEVER 4=PACKED + GAG	D E F G H J	C=1/2 D=3/4 E=1 F=1-1/4 G=1-1/2 H=2	B=MNPT X FNPT	J=SEC VIII LIQUID K=SEC VIII AIR L=SEC VIII STEAM M=NON CODE LIQUID N=NON CODE AIR / GAS P=NON CODE STEAM Q=VACUUM	M=METAL K=TEFLON	FACTORY ISSUED LETTERS / NUMBERS FOR SPECIAL OPTIONS OR FEATURES "AA"=DEFAULT STANDARD. "HT" HIGH TEMP. SPRING	SET PRESSURE, PSIG (4 DIGITS) VACUUM "HG" PREFIX+ 2 DIGIT			

- Notes:
- The ASME Code Section VIII requires a lift lever for the following services: air, steam, or hot water over 140°F
 - Maximum back pressure is 50 psig.
 - High temperature stainless steel alloy spring is required above 422°F / 217°C. Specify option "HT"
 - Service limits for Teflon® seat: -330 to +450°F / -201 to 232°C

Valve Dimensions And Weights

Model No.	Orifice Designation	Size Inlet x Outlet	A (mm)	Screwed Cap B (mm)	Packed Lever B (mm)	C (mm)	Weight Each lb. (kg)
5xxDC	D	1/2 X 1	2-3/8 (60)	7-1/2 (191)	7-1/2 (191)	1-5/8 (41)	2 (.91)
5xxDD	D	3/4 X 1	2-3/8 (60)	7-1/2 (191)	7-1/2 (191)	1-5/8 (41)	2 (.91)
5xxED	E	3/4 X 1-1/4	2-5/8 (67)	9 (229)	9 (229)	2 (51)	3 (1.37)
5xxEE	E	1 X 1-1/4	2-5/8 (67)	9 (229)	9 (229)	2 (51)	3 (1.37)
5xxFE	F	1 X 1-1/2	2-7/8 (73)	10-1/4 (260)	10-1/4 (260)	2-3/8 (60)	5 (2.27)
5xxFF	F	1-1/4 X 1-1/2	2-7/8 (73)	10-1/4 (260)	10-1/4 (260)	2-3/8 (60)	5 (2.27)
5xxGF	G	1-1/4 X 2	3-1/4 (83)	13-1/4 (337)	13-1/4 (337)	2-5/8 (67)	9 (4.1)
5xxGG	G	1-1/2 X 2	3-1/4 (83)	13-1/4 (337)	13-1/4 (337)	2-5/8 (67)	9.5 (4.31)
5xxHG	H	1-1/2 X 2-1/2	3-1/2 (89)	15 (381)	15 (381)	2-3/4 (70)	15.5 (7.0)
5xxHH	H	2 X 2-1/2	3-1/2 (89)	15 (381)	15 (381)	2-3/4 (70)	16 (7.3)
5xxJH	J	2 X 3	4 (102)	17 (432)	17 (432)	3-1/4 (83)	27 (12.2)

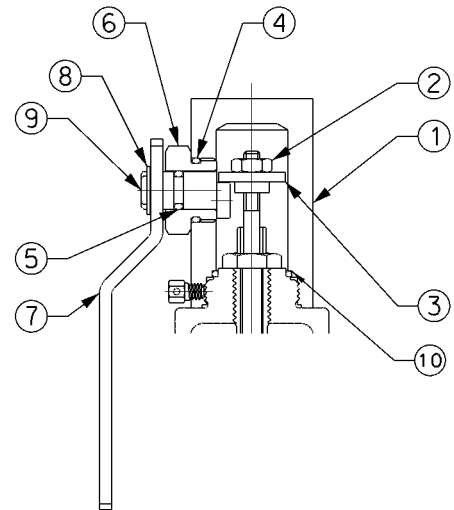
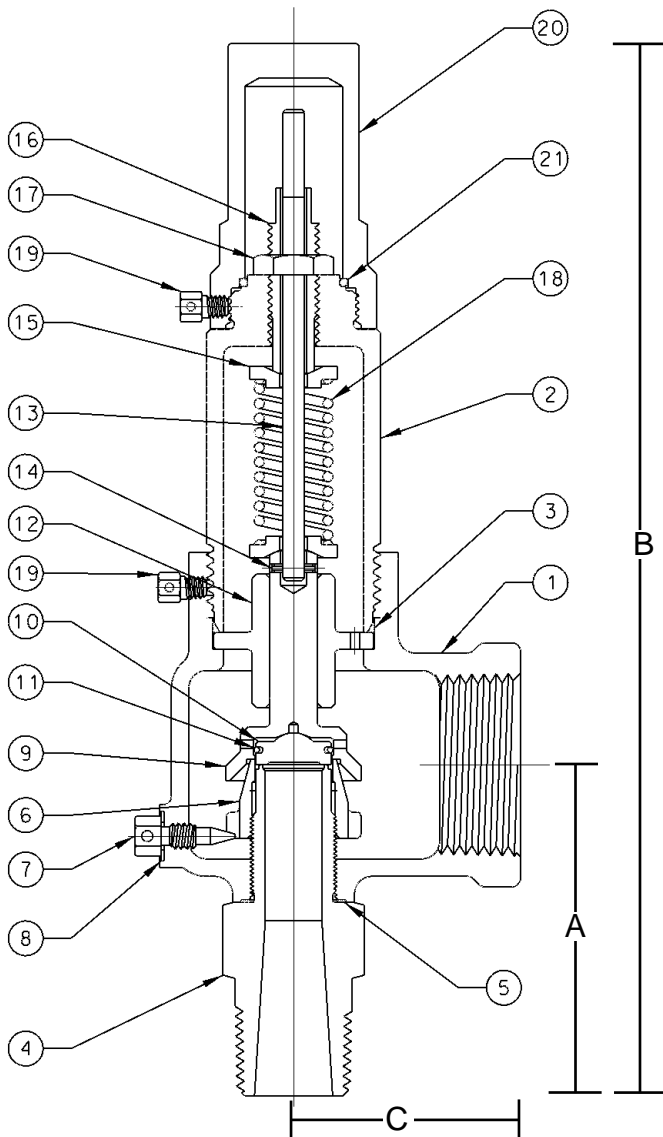

Packed Lever Detail

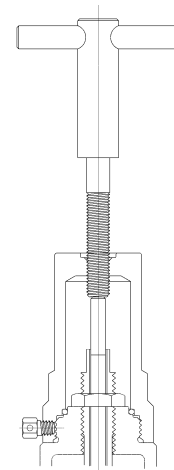

Test Gag Detail

Materials Of Construction

Item	Component	Material 510 Series	Material 520 Series	Material 530 Series	Material 540 series
1	Body	Bronze B-584-C844	BronzeB-584-C844	Steel SA-216 WCB	SS SA-351-CF8M
2	Bonnet	Brass*	Brass*	Steel	SS Type 316
3	Bonnet Seal	PTFE	PTFE	PTFE	PTFE
4	Nozzle	Brass B-16	SS Type 316	SS Type 316	SS Type 316
5	Nozzle Seal	PTFE	PTFE	PTFE	PTFE
6	Nozzle Ring	SS Type 316	SS Type 316	SS Type 316	SS Type 316
7	Set Screw	Brass	Brass	SS Type 316	SS Type 316
8	Set Screw Seal	PTFE	PTFE	PTFE	PTFE
9	Disc Holder	Brass	SS Type 316	SS Type 316	SS Type 316
10	Disc	SS Type 316	SS type 316	SS Type 316	SS Type 316
11	Retaining Ring	Stainless Steel	Stainless Steel	Stainless Steel	Stainless Steel
12	Disc Guide	Brass	Brass	SS Type 316	SS Type 316
13	Stem	Brass	Brass	SS Type 316	SS Type 316
14	Spring Pin	Stainless Steel	Stainless Steel	Stainless Steel	Stainless Steel
15	Spring Washer	Brass	Brass	SS Type 316	SS Type 316
16	Adjusting Bolt	Brass	Brass	SS Type 316	SS Type 316
17	Locknut	Brass	Brass	SS Type 316	SS Type 316
18	Spring	Stainless Steel	Stainless Steel	Stainless Steel	Stainless Steel
	Spring, High Temp.	Inconel	Inconel	Inconel	Inconel
19	Lock Screw	Stainless Steel	Stainless Steel	Stainless Steel	Stainless Steel
20	Cap, Screwed	Brass	Brass	Steel	SS Type 316
21	Seal, Cap	Viton	Viton	Viton	Viton
-	Nameplate	Stainless Steel	Stainless Steel	Stainless Steel	Stainless Steel
-	Drive Screw	Stainless Steel	Stainless Steel	Stainless Steel	Stainless Steel
-	Seal & Wire	Lead/SS	Lead/SS	Lead/SS	Lead/SS

Notes:
* - Sizes G, H and J are Cast Bronze

Materials Of Construction, Lift Lever Option

Item	Component	Material 513, 523 Series	Material 533 Series	Material 543 Series
1	Cap, Packed Lever	Brass	Steel	SS Type 316
2	Locknut	SS Type 316	SS Type 316	SS Type 316
3	Lift Nut	SS Type 316	SS Type 316	SS Type 316
4	Seal, Retainer	Viton	Viton	Viton
5	Seal, Cam	Viton	Viton	Viton
6	Cam Bushing	Brass	SS Type 316	SS Type 316
7	Lever	Stainless Steel	Stainless Steel	Stainless Steel
8	Retaining Ring	Stainless Steel	Stainless Steel	Stainless Steel
9	Lift cam	SS Type 316	SS Type 316	SS Type 316
10	Seal, Cap	Viton	Viton	Viton

Pressure And Temperature Ratings

Series	510	520	530	540
Body	Bronze	Bronze	Carbon Steel	Stainless Steel
Trim	Brass	Stainless	Stainless	Stainless
Max. Set-Steam	250 PSI	300 PSI	900 PSI	900 PSI
Max. Set-Air/Gas/Liquid	300 PSI	900 PSI	900 PSI	900 PSI
Temp. Limits	-60 / 406°F	-60 / 422°F	-20 / 800°F	-60 / 800°F

Note: Specify "HT" high temperature Inconel springs for service temperatures beyond 422°F.

CONBRACO 500 Series High Pressure Safety Relief Valve

ASME SECTION VIII STEAM

POUNDS PER HOUR OF SATURATED STEAM @ 10% OVERPRESSURE.
 NATIONAL BOARD CERTIFIED. RATINGS ARE 90% OF ACTUAL.

Orifice Letter Area, in ²	D 0.1295	E 0.2282	F 0.3589	G 0.5890	H 0.9195	J 1.5044
Set Pressure PSIG						
15	188	331	520	853	1332	2180
20	216	381	600	984	1536	2513
25	245	432	679	1114	1740	2846
30	274	482	759	1245	1943	3180
35	305	538	846	1388	2168	3546
40	337	593	934	1532	2392	3913
45	368	649	1021	1676	2616	4280
50	400	705	1108	1819	2840	4646
55	431	760	1196	1963	3064	5013
60	463	816	1283	2106	3288	5380
65	494	872	1371	2250	3512	5746
70	526	927	1458	2393	3736	6113
75	558	983	1546	2537	3960	6479
80	589	1038	1633	2680	4184	6846
85	621	1094	1721	2824	4408	7213
90	652	1150	1808	2968	4632	7579
95	684	1205	1896	3111	4857	7946
100	715	1261	1983	3255	5081	8313
125	873	1539	2421	3972	6201	10146
150	1031	1817	2858	4690	7322	11979
175	1189	2095	3295	5408	8442	13812
200	1346	2373	3733	6126	9562	15645
225	1504	2651	4170	6843	10683	17478
250	1662	2929	4607	7561	11803	19312
275	1820	3207	5045	8279	12924	21145
300	1977	3485	5482	8997	14044	22978
325	2135	3763	5919	9714	15165	24811
350	2293	4041	6357	10432	16285	26644
375	2451	4319	6794	11150	17405	28477
400	2608	4597	7231	11867	18526	30311
425	2766	4875	7669	12585	19646	32144
450	2924	5153	8106	13303	20767	33977
475	3082	5431	8543	14021	21887	35810
500	3239	5709	8981	14738	23008	37643
525	3397	5987	9418	15456		
550	3555	6266	9855	16174		
575	3713	6544	10293	16892		
600	3870	6822	10730	17609		
625	4028	7100				
650	4186	7378				
675	4344	7656				
700	4501	7934				
725	4659	8212				
750	4817	8490				
775	4975	8768				
800	5132	9046				
825	5290	9324				
850	5448	9602				
875	5606	9880				
900	5763	10158				
Approx. 1 psi Increment	6.3	11.1	17.5	28.7	44.8	73.3



US CUSTOMARY UNITS lb/hr

Set Pressure Limits
 510 Series - 250 psig
 520 Series - 300 psig
 530 Series - 900 psig
 540 Series - 900 psig

For steam service beyond 300 psig or 422°F specify option "HT" high temperature stainless steel alloy spring.

CONBRACO 500 Series Safety Relief Valve

ASME SECTION VIII AIR

STANDARD CUBIC FEET OF AIR PER MINUTE @ 10% OVERPRESSURE.
 NATIONAL BOARD CERTIFIED. RATINGS ARE 90% OF ACTUAL.

Orifice Letter Area, in ²	D 0.1295	E 0.2282	F 0.3589	G 0.5890	H 0.9195	J 1.5044
Set Pressure PSIG						
15	67	118	185	304	474	776
20	77	136	213	350	547	895
25	87	154	242	397	619	1013
30	97	172	270	443	692	1132
35	109	191	301	494	772	1262
40	120	211	332	545	851	1393
45	131	231	363	596	931	1523
50	142	251	395	648	1011	1654
55	154	271	426	699	1091	1784
60	165	290	457	750	1170	1915
65	176	310	488	801	1250	2045
70	187	330	519	852	1330	2176
75	198	350	550	903	1410	2306
80	210	370	581	954	1489	2437
85	221	389	612	1005	1569	2567
90	232	409	644	1056	1649	2698
95	243	429	675	1107	1729	2828
100	255	449	706	1158	1808	2959
125	311	548	862	1414	2207	3611
150	367	647	1017	1669	2606	4264
175	423	746	1173	1925	3005	4916
200	479	845	1329	2180	3404	5569
225	535	944	1484	2436	3802	6221
250	592	1043	1640	2691	4201	6874
275	648	1142	1796	2947	4600	7526
300	704	1240	1951	3202	4999	8179
325	760	1339	2107	3458	5398	8831
350	816	1438	2263	3713	5796	9484
375	872	1537	2418	3969	6195	10136
400	928	1636	2574	4224	6594	10789
425	985	1735	2730	4480	6993	11441
450	1041	1834	2885	4735	7392	12094
475	1097	1933	3041	4991	7791	12746
500	1153	2032	3197	5246	8189	13399
525	1209	2131	3352	5501		
550	1265	2230	3508	5757		
575	1321	2329	3664	6012		
600	1378	2428	3819	6268		
625	1434	2527				
650	1490	2626				
675	1546	2725				
700	1602	2824				
725	1658	2923				
750	1715	3022				
775	1771	3121				
800	1827	3220				
825	1883	3319				
850	1939	3418				
875	1995	3517				
900	2051	3616				
Approx. 1 psi Increment	2.2	4.0	6.2	10.2	16.0	26.1



**US CUSTOMARY UNITS
SCFM**

Set Pressure Limits
 510 Series - 300 psig
 520 Series - 900 psig
 530 Series - 900 psig
 540 Series - 900 psig

CONBRACO 500 Series High Pressure Safety Relief Valve

ASME SECTION VIII WATER

US GALLONS PER MINUTE OF WATER @ 10% OVERPRESSURE.
 NATIONAL BOARD CERTIFIED. RATINGS ARE 90% OF ACTUAL.

Orifice Letter Area, in ²	D 0.1295	E 0.2282	F 0.3589	G 0.5890	H 0.9195	J 1.5044
Set Pressure PSIG						
15	14	25	40	65	102	167
20	16	29	45	74	115	189
25	18	32	50	82	127	208
30	19	34	54	89	138	226
35	21	37	58	96	149	244
40	22	40	62	102	160	261
45	24	42	66	108	169	277
50	25	44	70	114	178	292
55	26	46	73	120	187	306
60	28	48	76	125	195	320
65	29	50	79	130	203	333
70	30	52	82	135	211	345
75	31	54	85	140	218	357
80	32	56	88	145	226	369
85	33	58	91	149	233	381
90	34	59	93	153	239	392
95	35	61	96	158	246	402
100	36	63	98	162	252	413
125	40	70	110	181	282	462
150	44	77	121	198	309	506
175	47	83	130	214	334	546
200	50	89	139	229	357	584
225	53	94	148	242	378	619
250	56	99	156	256	399	653
275	59	104	163	268	418	685
300	62	108	171	280	437	715
325	64	113	178	291	455	744
350	66	117	184	302	472	772
375	69	121	191	313	489	799
400	71	125	197	323	505	826
425	73	129	203	333	520	851
450	75	133	209	343	535	876
475	77	136	215	352	550	900
500	79	140	220	361	564	923
525	81	143	226	370		
550	83	147	231	379		
575	85	150	236	388		
600	87	153	241	396		
625	89	157				
650	91	160				
675	92	163				
700	94	166				
725	96	169				
750	97	171				
775	99	174				
800	100	177				
825	102	180				
850	104	183				
875	105	185				
900	107	188				



US CUSTOMARY UNITS GPM

Set Pressure Limits
 510 Series - 300 psig
 520 Series - 300 psig
 530 Series - 900 psig
 540 Series - 900 psig

Note: To determine water capacity at 25% overpressure, multiply the capacity at 10% by 1.066.

CONBRACO 500 Series High Pressure Safety Relief Valve

ASME SECTION VIII STEAM

KILOGRAMS PER HOUR OF SATURATED STEAM @ 10% OVERPRESSURE.
NATIONAL BOARD CERTIFIED. RATINGS ARE 90% OF ACTUAL.

Orifice Letter Area, cm ²	D 0.8352	E 1.4721	F 2.3155	G 3.8001	H 5.9321	J 9.7058
Set Pressure(barg)						
1.1	88	154	243	398	622	1018
2	122	214	337	553	863	1412
3	163	287	451	741	1156	1892
4	204	360	566	930	1451	2374
5	246	433	681	1118	1746	2857
6	287	506	797	1307	2041	3339
7	329	580	912	1496	2336	3821
8	370	653	1027	1685	2630	4304
9	412	726	1142	1874	2925	4786
10	453	799	1257	2063	3220	5269
12	536	945	1487	2441	3810	6233
14	619	1092	1717	2818	4400	7198
16	702	1238	1947	3196	4989	8163
18	786	1384	2178	3574	5579	9128
20	869	1531	2408	3952	6169	10093
22	952	1677	2638	4329	6758	11058
24	1035	1823	2868	4707	7348	12022
26	1118	1970	3098	5085	7938	12987
28	1201	2116	3329	5463	8527	13952
30	1284	2262	3559	5840	9117	14917
32	1367	2409	3789	6218	9707	15882
34	1450	2555	4019	6596	10297	16846
36	1533	2701	4249	6974		
38	1616	2848	4479	7351		
40	1699	2994	4710	7729		
42	1782	3140				
44	1865	3287				
46	1948	3433				
48	2031	3579				
50	2114	3726				
52	2197	3872				
54	2280	4019				
58	2446	4311				
62	2612	4604				
Approx. 0.1 bar Increment	4.15	7.32	11.51	18.89	29.48	48.24



METRIC UNITS
Kg/Hr

Set Pressure Limits
510 Series - 17.3 barg
520 Series - 20.7 barg
530 Series - 62.1 barg
540 Series - 62.1 barg

For steam service beyond 20.7 barg or 217°C specify option "HT" high temperature stainless steel alloy spring.

CONBRACO 500 Series High Pressure Safety Relief Valve

ASME SECTION VIII AIR

NORMALIZED CUBIC METERS OF AIR PER HOUR @ 10% OVERPRESSURE.
NATIONAL BOARD CERTIFIED. RATINGS ARE 90% OF ACTUAL.

Orifice Letter Area, cm ²	D 0.8352	E 1.4721	F 2.3155	G 3.8001	H 5.9321	J 9.7058
Set Pressure(barg)						
1.1	110	195	306	503	784	1283
2	153	270	425	697	1089	1781
3	205	362	569	934	1458	2386
4	258	454	714	1172	1830	2994
5	310	546	859	1411	2202	3603
6	362	639	1005	1649	2574	4211
7	415	731	1150	1887	2946	4819
8	467	823	1295	2125	3317	5428
9	519	916	1440	2363	3689	6036
10	572	1008	1585	2601	4061	6644
12	676	1192	1875	3078	4805	7861
14	781	1377	2166	3554	5548	9078
16	886	1561	2456	4031	6292	10295
18	991	1746	2746	4507	7036	11511
20	1095	1931	3037	4983	7779	12728
22	1200	2115	3327	5460	8523	13945
24	1305	2300	3617	5936	9267	15162
26	1409	2484	3907	6413	10010	16378
28	1514	2669	4198	6889	10754	17595
30	1619	2853	4488	7365	11498	18812
32	1724	3038	4778	7842	12241	20029
34	1828	3222	5069	8318	12985	21245
36	1933	3407	5359	8795		
38	2038	3591	5649	9271		
40	2142	3776	5939	9747		
42	2247	3961				
44	2352	4145				
46	2457	4330				
48	2561	4514				
50	2666	4699				
52	2771	4883				
54	2875	5068				
58	3085	5437				
62	3294	5806				
Approx. 0.1 bar Increment	5.24	9.23	14.51	23.82	37.18	60.84



METRIC UNITS Nm³/Hr

Set Pressure Limits
510 Series - 20.7 barg
520 Series - 62.1 barg
530 Series - 62.1 barg
540 Series - 62.1 barg

CONBRACO 500 Series High Pressure Safety Relief Valve

ASME SECTION VIII WATER

CUBIC METERS OF WATER PER HOUR @ 10% OVERPRESSURE.
 NATIONAL BOARD CERTIFIED. RATINGS ARE 90% OF ACTUAL.

Orifice Letter Area, cm ²	D 0.8352	E 1.4721	F 2.3155	G 3.8001	H 5.9321	J 9.7058
Set Pressure(barg)						
1.1	3.3	5.9	9.3	15.2	23.8	38.9
2	4.4	7.7	12.1	19.8	30.9	50.6
3	5.3	9.4	14.8	24.2	37.8	61.8
4	6.1	10.8	17.0	28.0	43.6	71.4
5	6.9	12.1	19.0	31.3	48.8	79.8
6	7.5	13.3	20.9	34.2	53.4	87.4
7	8.1	14.3	22.5	37.0	57.7	94.5
8	8.7	15.3	24.1	39.5	61.7	101.0
9	9.2	16.2	25.6	41.9	65.5	107.1
10	9.7	17.1	26.9	44.2	69.0	112.9
12	10.6	18.8	29.5	48.4	75.6	123.7
14	11.5	20.3	31.9	52.3	81.6	133.6
16	12.3	21.7	34.1	55.9	87.3	142.8
18	13.0	23.0	36.1	59.3	92.6	151.5
20	13.7	24.2	38.1	62.5	97.6	159.7
22	14.4	25.4	39.9	65.6	102.3	167.5
24	15.1	26.5	41.7	68.5	106.9	174.9
26	15.7	27.6	43.4	71.3	111.3	182.0
28	16.3	28.7	45.1	74.0	115.5	188.9
30	16.8	29.7	46.7	76.6	119.5	195.5
32	17.4	30.6	48.2	79.1	123.4	202.0
34	17.9	31.6	49.7	81.5	127.2	208.2
36	18.4	32.5	51.1	83.9		
38	18.9	33.4	52.5	86.2		
40	19.4	34.2	53.9	88.4		
42	19.9	35.1				
44	20.4	35.9				
46	20.8	36.7				
48	21.3	37.5				
50	21.7	38.3				
52	22.2	39.0				
54	22.6	39.8				
58	23.4	41.2				
62	24.2	42.6				



METRIC UNITS
m³/Hr

Set Pressure Limits
 510 Series - 20.7 barg
 520 Series - 62.1 barg
 530 Series - 62.1 barg
 540 Series - 62.1 barg

Note: To determine water capacity at 25% overpressure, multiply the capacity at 10% by 1.066.



Other Conbraco Literature For Your Specification Library

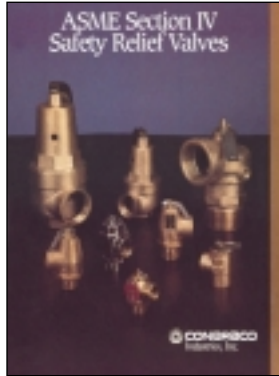

ASME Section IV
Safety Relief Brochure

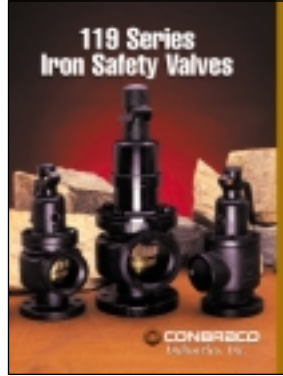

119 Series Catalog



19/29 Brochure



In-Line Check Valve
Brochure



Strainers Catalog

Warranty And Limitations Of Liability

Conbraco Industries, Inc. warrants, to its initial purchaser only, that its products which are delivered to this initial purchaser will be of the kind described in the order or price list and will be free of defects in workmanship or material for a period of one year from the date of delivery to you, our initial purchaser.

Should any failure to conform to this warranty appear within one year after the date of the initial delivery to our initial purchaser, Conbraco will, upon written notification thereof and substantiation that the goods have been stored, installed, maintained and operated in accordance with Conbraco's recommendations and standard industry practice, correct such defects by suitable repair or replacement at Conbraco's own expense.

THIS WARRANTY IS EXCLUSIVE AND IS IN LIEU OF ANY IMPLIED WARRANTY OF MERCHANTABILITY, FITNESS FOR A PARTICULAR PURPOSE OR OTHER WARRANTY, WHETHER EXPRESS OR IMPLIED, EXCEPT THE WARRANTY OF TITLE AND AGAINST PATENT INFRINGEMENT.

Correction of non-conformities, in the manner and for the period of time provided above, shall constitute fulfillment of all liabilities of Conbraco to our initial purchaser, with respect to the goods, whether based on contract, negligence, strict tort or otherwise. It is the intention of Conbraco Industries, Inc. that no warranty of any kind, whether express or implied shall pass through our initial purchaser to any other person or corporation.

LIMITATION OF LIABILITY: Conbraco Industries, Inc. SHALL NOT UNDER ANY CIRCUMSTANCES BE LIABLE FOR SPECIAL OR CONSEQUENTIAL DAMAGES SUCH AS, BUT NOT LIMITED TO, DAMAGE TO LOSS OF OTHER PROPERTY OR EQUIPMENT, LOSS OF PROFITS OR REVENUE, COST OF CAPITAL, COST OF PURCHASED OR REPLACEMENT GOODS, OR CLAIMS OF CUSTOMERS OF OUR INITIAL PURCHASER. THE REMEDIES OF OUR INITIAL PURCHASER, AND ALL OTHERS, SET FORTH HEREIN, ARE EXCLUSIVE, AND THE LIABILITY OF CONBRACO WITH RESPECT TO SAME SHALL NOT, EXCEPT AS EXPRESSLY PROVIDED HEREIN, EXCEED THE PRICE OF THE CONBRACO GOODS UPON WHICH SUCH LIABILITY IS BASED.

To learn more about new Conbraco Series 500 Section VIII safety relief valves, or to place an order, see your Conbraco distributor. Or contact Conbraco's customer service department. Phone (704) 841 - 6000; Fax (704) 841 - 6020.



Your local Conbraco distributor is:



Conbraco Industries, Inc.
P.O. Box 247
Matthews, NC 28106
(704) 841 - 6000
Fax: (704) 841 - 6020
www.conbraco.com



Apollo® and Conbraco are a registered trademarks of Conbraco Industries Inc. which reserves the right to change specifications without notice. © 2001 Conbraco Industries Inc.